

## 4 Zone Dimming and CCT RF Remote Controller

Model No.: RA1, RA2

4 zone/16 key/Wireless remote 30m distance/AAA x 2 battery



RA1  
4 zone dimming



RA2  
4 zone CCT

CE RoHS  LVD RED

### Features

- Apply to single color or dual color LED controller.
- Each remote can match one or more receiver.
- AAAx2 battery powered.
- Operate with LED indicator light.

### Technical Parameters

Input and Output	
Output signal	RF(2.4GHz)
Working voltage	3VDC(AAAx2)
Working current	< 5mA
Standby current	< 2μA
Standby time	2 year
Remote distance	30m(Barrier-free space)

Warranty	
Warranty	5 years

Safety and EMC	
EMC standard [EMC]	ETSI EN 301 489-1 V2.2.3 ETSI EN 301 489-17 V3.2.4
Safety standard[LVD]	EN 62368-1:2020+A11:2020
Radio Equipment[RED]	ETSI EN 300 328 V2.2.2
Certification	CE,EMC,LVD,RED

Environment	
Operation temperature	To: -30°C ~ +55°C
IP rating	IP20

### Mechanical Structures and Installations

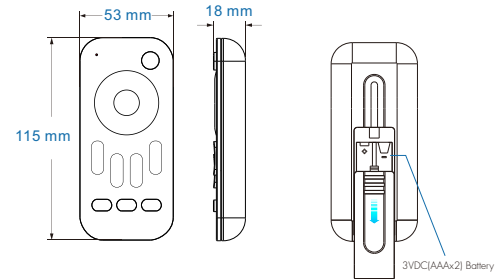

### Key function

- RA1 4 zone dimming remote

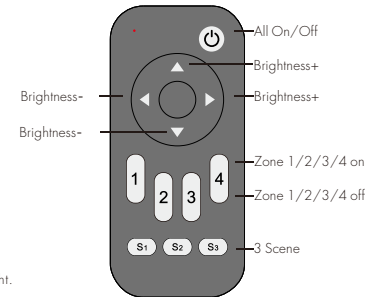

#### All on/off:

Turn on/off all 4 zone light.

#### Zone 1/2/3/4 on/off:

Turn on/off zone light, at the same time, select current zone.

Short press multiple zone on key fastly, will select multiple zone synchronously.

#### Brightness+/-:

Adjust current selected zone brightness.

Short press 10 levels, long press 1-6s for continuous 256 levels adjustment.

#### Scene 1/2/3:

Short press recall the scene, long press 2s save current state into S1/2/3.

the LED indicator will light up longer when save OK.

4 zone recall or save synchronously.

● RA2 4 zone CCT remote

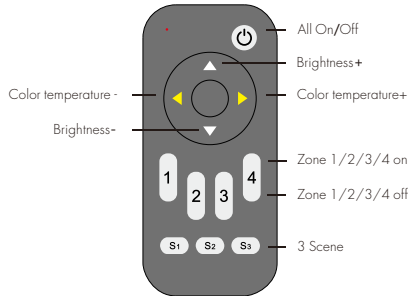

**All on/off:**

Turn on/off all 4 zone light.

**Zone 1/2/3/4 on/off:**

Turn on/off zone light, at the same time, select current zone.

Short press multiple zone on key fastly, will select multiple zone synchronously.

**Brightness+/-:**

Adjust current selected zone brightness.

Short press 10 levels, long press 1-6s for continuous 256 levels adjustment.

**Color temperature+/-:**

Adjust current selected zone color temperature.

Short press 11 levels, long press 1-6s for continuous 256 levels adjustment.



**Scene 1/2/3:**

Short press recall the scene, long press 2s save current state into S1/2/3.

the LED indicator will light up longer when save OK.

4 zone recall or save synchronously.

**Match Remote Control (two match ways)**

End user can choose the suitable match/delete ways. Two options are offered for selection:

**Use the controller's Match key**

**Match:**

Short press match key, immediately press zone on key on the remote. The LED indicator fast flash a few times means match is successful.

**Delete:**

Press and hold match key for 5s to delete all match, The LED indicator fast flash a few times means all matched remotes were deleted.

**Use Power Restart**

**Match:**

Switch off the power, then switch on power, repeat again. Immediately short press zone on key 3 times on the remote. The light blinks 3 times means match is successful.

**Delete:**

Switch off the power, then switch on power, repeat again. Immediately short press zone on key 5 times on the remote. The light blinks 5 times means all matched remotes were deleted.

**Safety information**

1. Read all instructions carefully before you begin this installation.
2. When installing battery, pay attention to the battery positive and negative polarity. A long time without the remote control, remove the battery. When remote distance becomes smaller and insensitive, replace the battery.
3. If no response from the receiver, please re-match the remote.
4. Gently handle remote, beware of falling.
5. For indoor and dry location use only.